

**PCFTR35-XL**

Flanged housing unit

Housing units PCFTR, three-bolt flanged housing units, cast iron, eccentric locking collar, P seals

X-life

Technical information

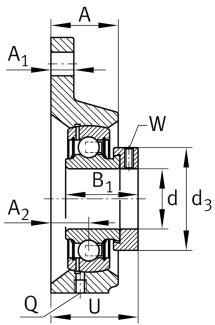
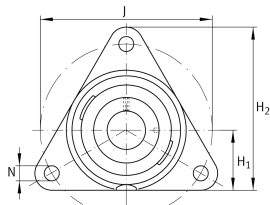

Your current product variant

Material	GG	Grey cast iron
----------	----	----------------

Main Dimensions & Performance Data

d	35 mm	Bore diameter
H ₂	128 mm	Height flange
U	45,1 mm	Total height unit
C _r	27.500 N	Basic dynamic load rating, radial
C _{0r}	15.300 N	Basic static load rating, radial
≈m	1,28 kg	Weight

Mounting dimensions

J	129,7 mm	Pitch circle diameter (holes)
N	14 mm	Fixing bore
n	3	Number of screwing holes



Dimensions

A	27 mm	Height housing
A ₁	14 mm	Thickness of flange
A ₂	15,6 mm	Distance raceway
H ₁	48 mm	Distance shaft axis
Q	M6	Connection thread for lubrication
d ₃	55 mm	Outside diameter eccentric locking collar

Additional information

1	Number of housings
CFTR07	Housing
GRAE35-XL-NPP-B	Bearing designation

Temperature range

T _{min}	-20 °C	Operating temperature min.
T _{max}	120 °C	Operating temperature max.