

**PCFTR45-XL**

## Flanged housing unit

Housing units PCFTR, three-bolt flanged housing units, cast iron, eccentric locking collar, P seals

X-life

## Technical information

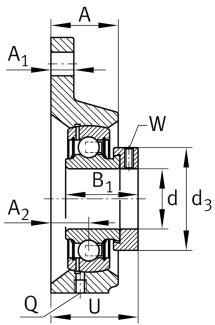
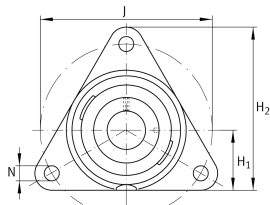

## Your current product variant

Material	GG	Grey cast iron
----------	----	----------------

## Main Dimensions &amp; Performance Data

d	45 mm	Bore diameter
H <sub>2</sub>	150 mm	Height flange
U	51,9 mm	Total height unit
C <sub>r</sub>	32.500 N	Basic dynamic load rating, radial
C <sub>0r</sub>	20.400 N	Basic static load rating, radial
≈m	2,08 kg	Weight

## Mounting dimensions

J	160 mm	Pitch circle diameter (holes)
N	14 mm	Fixing bore
n	3	Number of screwing holes



### Dimensions

A	33 mm	Height housing
A <sub>1</sub>	16 mm	Thickness of flange
A <sub>2</sub>	19,2 mm	Distance raceway
H <sub>1</sub>	55 mm	Distance shaft axis
Q	M6	Connection thread for lubrication
d <sub>3</sub>	63 mm	Outside diameter eccentric locking collar

### Additional information

1	Number of housings
CFTR09	Housing
GRAE45-XL-NPP-B	Bearing designation

### Temperature range

T <sub>min</sub>	-20 °C	Operating temperature min.
T <sub>max</sub>	120 °C	Operating temperature max.