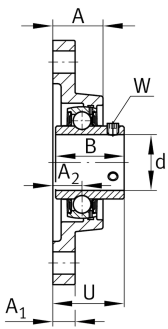

**FAG****UCFL216** [↗](#)

Flanged housing unit

Flanged housing unit UCFL

## Technical information

**Your current product variant**

|          |    |                |
|----------|----|----------------|
| Material | GG | Grey cast iron |
|----------|----|----------------|

**Main Dimensions & Performance Data**

|                 |          |                                   |
|-----------------|----------|-----------------------------------|
| d               | 80 mm    | Bore diameter                     |
| L               | 180 mm   | Flange width                      |
| H               | 290 mm   | Height flange                     |
| U               | 83,3 mm  | Total height unit                 |
| C <sub>r</sub>  | 76.000 N | Basic dynamic load rating, radial |
| C <sub>0r</sub> | 54.000 N | Basic static load rating, radial  |
| C <sub>ur</sub> | 2.700 N  | Fatigue load limit, radial        |
| ≈m              | 7,24 kg  | Weight                            |

**Mounting dimensions**

|   |        |                          |
|---|--------|--------------------------|
| J | 233 mm | Distance fixing bore     |
| N | 25 mm  | Fixing bore              |
| n | 2      | Number of screwing holes |



### Dimensions

|                |         |                                   |
|----------------|---------|-----------------------------------|
| A              | 58 mm   | Height housing                    |
| A <sub>1</sub> | 24 mm   | Thickness of flange               |
| A <sub>2</sub> | 34 mm   | Distance raceway                  |
| B              | 82,8 mm | Width                             |
| Q              | M6      | Connection thread for lubrication |

### Additional information

|       |                     |
|-------|---------------------|
| 1     | Number of housings  |
| FL216 | Housing             |
| UC216 | Bearing designation |

### Temperature range

|                  |        |                            |
|------------------|--------|----------------------------|
| T <sub>min</sub> | -20 °C | Operating temperature min. |
| T <sub>max</sub> | 120 °C | Operating temperature max. |