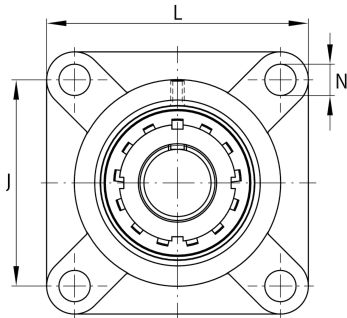
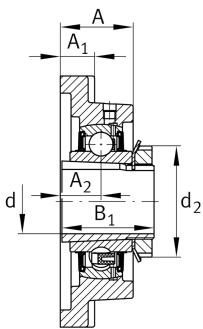

**FAG****UKF210**

Flanged housing unit

Flanged housing unit UKF

## Technical information

**Your current product variant**

Material	GG	Grey cast iron
----------	----	----------------

**Main Dimensions & Performance Data**

d	45 mm	Bore diameter
L	143 mm	Flange width
$C_r$	37.500 N	Basic dynamic load rating, radial
$C_{0r}$	23.200 N	Basic static load rating, radial
$C_{ur}$	1.210 N	Fatigue load limit, radial
$\approx m$	2,654 kg	Weight

**Mounting dimensions**

J	111 mm	Distance fixing bore
N	16 mm	Fixing bore
n	4	Number of screwing holes

**Dimensions**

A	40 mm	Height housing
$A_1$	18 mm	Thickness of flange
$A_2$	22 mm	Distance raceway
B	34 mm	Width
$B_1$	55 mm	Locking collar total width
$d_3$	70 mm	Outside diameter eccentric locking collar



### Additional information

---

1	Number of housings
F2105	Housing
UK210	Bearing designation

### Temperature range

---

T <sub>min</sub>	-20 °C	Operating temperature min.
T <sub>max</sub>	120 °C	Operating temperature max.