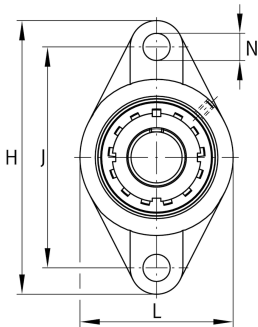
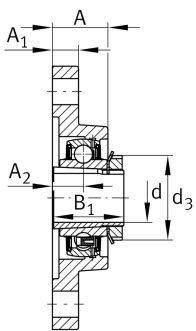
**FAG****UKFL208** [↗](#)

Flanged housing unit

Flanged housing unit UKFL

Technical information

**Your current product variant**

Material	GG	Grey cast iron
----------	----	----------------

Main Dimensions & Performance Data

d	35 mm	Bore diameter
L	100 mm	Flange width
H	175 mm	Height flange
C _r	34.500 N	Basic dynamic load rating, radial
C _{0r}	19.800 N	Basic static load rating, radial
C _{ur}	1.030 N	Fatigue load limit, radial
≈m	1,57 kg	Weight

Mounting dimensions

J	144 mm	Distance fixing bore
N	16 mm	Fixing bore
n	2	Number of screwing holes



Dimensions

A	36 mm	Height housing
A ₁	16 mm	Thickness of flange
A ₂	21 mm	Distance raceway
B	31 mm	Width
B ₁	46 mm	Locking collar total width
d ₃	58 mm	Outside diameter eccentric locking collar

Additional information

1	Number of housings
FL208	Housing
UK208	Bearing designation

Temperature range

T _{min}	-20 °C	Operating temperature min.
T _{max}	120 °C	Operating temperature max.