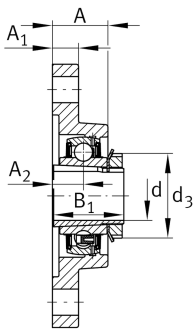

**FAG****UKFL209** [↗](#)

Flanged housing unit

Flanged housing unit UKFL

Technical information

**Your current product variant**

Material	GG	Grey cast iron
----------	----	----------------

Main Dimensions & Performance Data

d	40 mm	Bore diameter
L	108 mm	Flange width
H	188 mm	Height flange
C _r	34.500 N	Basic dynamic load rating, radial
C _{0r}	20.400 N	Basic static load rating, radial
C _{ur}	1.060 N	Fatigue load limit, radial
≈m	2,08 kg	Weight

Mounting dimensions

J	148 mm	Distance fixing bore
N	19 mm	Fixing bore
n	2	Number of screwing holes



Dimensions

A	38 mm	Height housing
A ₁	18 mm	Thickness of flange
A ₂	22 mm	Distance raceway
B	32 mm	Width
B ₁	50 mm	Locking collar total width
d ₃	65 mm	Outside diameter eccentric locking collar

Additional information

1	Number of housings
FL209	Housing
UK209	Bearing designation

Temperature range

T _{min}	-20 °C	Operating temperature min.
T _{max}	120 °C	Operating temperature max.