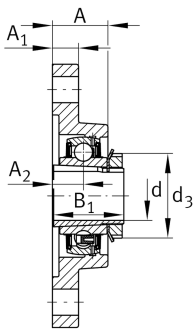

**FAG****UKFL212** [↗](#)

Flanged housing unit

Flanged housing unit UKFL

Technical information

**Your current product variant**

Material	GG	Grey cast iron
----------	----	----------------

Main Dimensions & Performance Data

d	55 mm	Bore diameter
L	140 mm	Flange width
H	250 mm	Height flange
C _r	56.000 N	Basic dynamic load rating, radial
C _{0r}	36.000 N	Basic static load rating, radial
C _{ur}	1.870 N	Fatigue load limit, radial
≈m	4,05 kg	Weight

Mounting dimensions

J	202 mm	Distance fixing bore
N	23 mm	Fixing bore
n	2	Number of screwing holes



Dimensions

A	48 mm	Height housing
A ₁	20 mm	Thickness of flange
A ₂	29 mm	Distance raceway
B	40 mm	Width
B ₁	62 mm	Locking collar total width
d ₃	80 mm	Outside diameter eccentric locking collar

Additional information

1	Number of housings
FL212	Housing
UK212	Bearing designation

Temperature range

T _{min}	-20 °C	Operating temperature min.
T _{max}	120 °C	Operating temperature max.