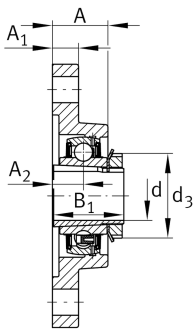
**FAG****UKFL213** [↗](#)

Flanged housing unit

Flanged housing unit UKFL

## Technical information

**Your current product variant**

Material	GG	Grey cast iron
----------	----	----------------

**Main Dimensions & Performance Data**

d	60 mm	Bore diameter
L	155 mm	Flange width
H	258 mm	Height flange
C <sub>r</sub>	61.000 N	Basic dynamic load rating, radial
C <sub>0r</sub>	40.000 N	Basic static load rating, radial
C <sub>ur</sub>	2.090 N	Fatigue load limit, radial
≈m	4,85 kg	Weight

**Mounting dimensions**

J	210 mm	Distance fixing bore
N	23 mm	Fixing bore
n	2	Number of screwing holes



### Dimensions

A	50 mm	Height housing
A <sub>1</sub>	24 mm	Thickness of flange
A <sub>2</sub>	30 mm	Distance raceway
B	41 mm	Width
B <sub>1</sub>	65 mm	Locking collar total width
d <sub>3</sub>	85 mm	Outside diameter eccentric locking collar

### Additional information

1	Number of housings
FL213	Housing
UK213	Bearing designation

### Temperature range

T <sub>min</sub>	-20 °C	Operating temperature min.
T <sub>max</sub>	120 °C	Operating temperature max.