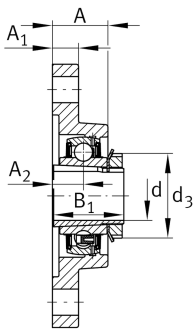

**FAG****UKFL216** [↗](#)

Flanged housing unit

Flanged housing unit UKFL

Technical information

**Your current product variant**

Material	GG	Grey cast iron
----------	----	----------------

Main Dimensions & Performance Data

d	70 mm	Bore diameter
L	180 mm	Flange width
H	290 mm	Height flange
C _r	76.000 N	Basic dynamic load rating, radial
C _{0r}	54.000 N	Basic static load rating, radial
C _{ur}	2.700 N	Fatigue load limit, radial
≈m	7,77 kg	Weight

Mounting dimensions

J	233 mm	Distance fixing bore
N	25 mm	Fixing bore
n	2	Number of screwing holes



Dimensions

A	58 mm	Height housing
A ₁	24 mm	Thickness of flange
A ₂	34 mm	Distance raceway
B	46 mm	Width
B ₁	78 mm	Locking collar total width
d ₃	105 mm	Outside diameter eccentric locking collar

Additional information

1	Number of housings
FL216	Housing
UK216	Bearing designation

Temperature range

T _{min}	-20 °C	Operating temperature min.
T _{max}	120 °C	Operating temperature max.