

**FLCTEY20-XL**

## Flanged housing unit

Housing units FLCTEY, two-bolt flanged housing units, cast iron, grub screws in inner ring, P seals, without relubrication facility

X-life

## Technical information

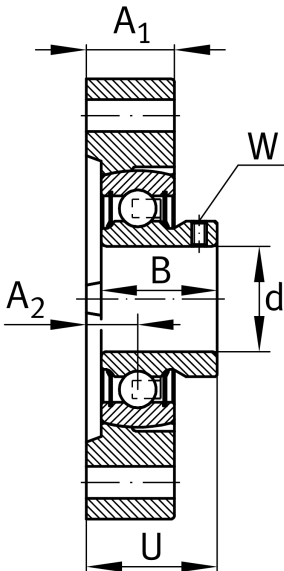

## Your current product variant

|          |    |                |
|----------|----|----------------|
| Material | GG | Grey cast iron |
|----------|----|----------------|

## Main Dimensions &amp; Performance Data

|                 |          |                                   |
|-----------------|----------|-----------------------------------|
| d               | 20 mm    | Bore diameter                     |
| L               | 66,5 mm  | Flange width                      |
| H               | 90,5 mm  | Height flange                     |
| U               | 27 mm    | Total height unit                 |
| C <sub>r</sub>  | 13.600 N | Basic dynamic load rating, radial |
| C <sub>0r</sub> | 6.600 N  | Basic static load rating, radial  |
| C <sub>ur</sub> | 345 N    | Fatigue load limit, radial        |
| ≈m              | 0,31 kg  | Weight                            |

## Mounting dimensions

|   |         |                               |
|---|---------|-------------------------------|
| J | 71,4 mm | Distance fixing bore          |
| J | 71,4 mm | Pitch circle diameter (holes) |
| N | 9 mm    | Fixing bore                   |
| n | 2       | Number of screwing holes      |



### Dimensions

|                |        |   |
|----------------|--------|---|
| A <sub>1</sub> | 17 mm  | Thickness of flange                       |
| A <sub>2</sub> | 9,5 mm | Distance raceway                          |
| d <sub>3</sub> | 33 mm  | Outside diameter eccentric locking collar |

### Additional information

|               |                     |
|---------------|---------------------|
| 1             | Number of housings  |
| LCTE04        | Housing             |
| AY20-XL-NPP-B | Bearing designation |

### Temperature range

|                  |        |                            |
|------------------|--------|----------------------------|
| T <sub>min</sub> | -20 °C | Operating temperature min. |
| T <sub>max</sub> | 120 °C | Operating temperature max. |