

**PCJT25-XL-N**

Flanged housing unit

Housing units PCJT, two-bolt flanged housing units, cast iron, eccentric locking collar, P seals

X-life

Technical information

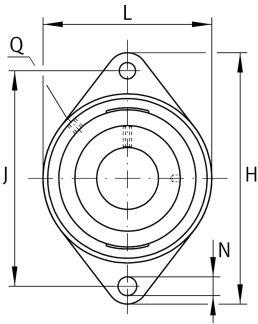

Your current product variant

Groove	N	Cast iron housing with undercut slot for end caps
Material	GG	Grey cast iron

Main Dimensions & Performance Data

d	25 mm	Bore diameter
L	70 mm	Flange width
H	124 mm	Height flange
U	42,5 mm	Total height unit
C _r	14.900 N	Basic dynamic load rating, radial
C _{0r}	7.800 N	Basic static load rating, radial
C _{ur}	370 N	Fatigue load limit, radial
≈m	0,58 kg	Weight

Mounting dimensions

J	99 mm	Distance fixing bore
N	11,5 mm	Fixing bore
n	2	Number of screwing holes
W	3 mm	Width of flats



Dimensions

A	28,5 mm	Height housing
A ₁	11 mm	Thickness of flange
A ₂	19 mm	Distance raceway
B ₁	31 mm	Locking collar total width
V	70 mm	Shoulder diameter housing
Q	M6	Connection thread for lubrication
d ₃	37,5 mm	Outside diameter locking collar

Additional information

GEHCJT05-GG-N	Housing
GRAE25-XL-NPP-B	Bearing designation
KASK05	Protecting cap

Temperature range

T _{min}	-20 °C	Operating temperature min.
T _{max}	100 °C	Operating temperature max.