

**RTUEO90-XL**

Take-up housing unit

Take-up housing units RTUEO, cast iron housing, radial insert ball bearing with eccentric locking collar, heavy series, R seals

X-life

Technical information

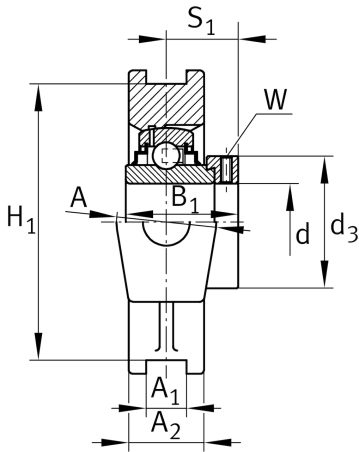

Your current product variant

Material	GG	Grey cast iron
----------	----	----------------

Main Dimensions & Performance Data

d	90 mm	Bore diameter
H	255 mm	Height
L	312 mm	Length total
B ₁	101 mm	Locking collar total width
m	22,26 kg	Weight

Mounting dimensions

A ₁	32 mm	Width guidance groove
	H13	Width guidance groove clearance
H ₁	228 mm	Distance guidance grooves
	0 mm	Upper distance guidance groove tolerance
	-0,6 mm	Lower distance guidance groove tolerance
N	57 mm	Fixing bore



Dimensions

L ₁	192 mm	Distance shaft axis
L ₂	30 mm	Length fixed link
L ₃	165 mm	Length guidance groove
A	110 mm	Width housing fixing side
N ₁	46 mm	Width recess
N ₂	106 mm	Height recess
S ₁	65,5 mm	Distance of raceway to locking collar
T	160 mm	Height housing fixing side
Q	M6	Connection thread for lubrication
A ₂	66 mm	Width housing

Additional information

TUEO18	Housing
GNE90-XL-KRR-B	Bearing designation

Temperature range

T _{min}	-20 °C	Operating temperature min.
T _{max}	120 °C	Operating temperature max.