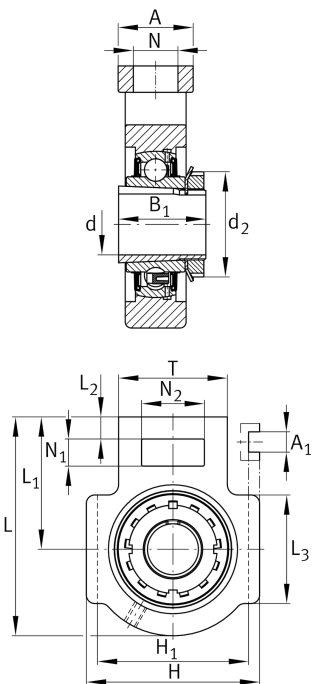

**FAG****UKT212**

Take-up housing unit

Housing units UKT, cast iron housing, radial insert ball bearing with adapter sleeve, RSR seals, for linear motion

Technical information

**Your current product variant**

Material	GG	Grey cast iron
----------	----	----------------

Main Dimensions & Performance Data

d	55 mm	Bore diameter
H	146 mm	Height
L	194 mm	Length total
B ₁	62 mm	Locking collar total width
≈m	4,79 kg	Weight

Mounting dimensions

A ₁	22 mm	Width guidance groove
	0,3 mm	Upper width guidance groove tolerance
	0 mm	Lower width guidance groove tolerance
H ₁	130 mm	Distance guidance grooves
	0 mm	Upper distance guidance groove tolerance
	-0,8 mm	Lower distance guidance groove tolerance
N	35 mm	Fixing bore



Dimensions

L ₁	119 mm	Distance shaft axis
L ₂	19 mm	Length fixed link
L ₃	102 mm	Length guidance groove
A	64 mm	Width housing fixing side
N ₁	32 mm	Width recess
N ₂	64 mm	Height recess
T	102 mm	Height housing fixing side
Q	M6	Connection thread for lubrication
A ₂	42 mm	Width housing

Additional information

T212	Housing
UK212	Bearing designation

Temperature range

T _{min}	-20 °C	Operating temperature min.
T _{max}	100 °C	Operating temperature max.