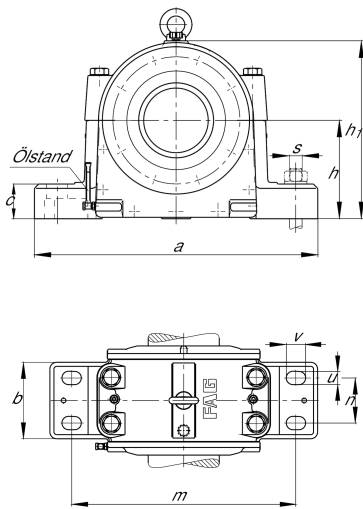

**FAG****LOE526-N-BF-L**

Plummer block housing

Plummer block housing, split, for spherical roller bearings, oil-lubrication

Technical information

**Main Dimensions & Performance Data**

| | | |
|----------------|--------|----------------|
| d | 115 mm | Shaft diameter |
| a | 570 mm | Length base |
| h ₁ | 345 mm | Height |
| g ₁ | 260 mm | Total width |
| ≈m | 100 kg | Weight |

Dimensions

| | | |
|---|--------|--------------------------|
| b | 175 mm | Width base |
| c | 65 mm | Height base |
| D | 230 mm | Outside diameter bearing |
| g | 185 mm | Width housing body |
| h | 190 mm | Center height |
| m | 460 mm | Distance fixing bore |
| n | 90 mm | Bore distance width |
| s | M30 | Size of fixing screws |
| u | 36 mm | Width slot |
| v | 50 mm | Length slot |

Additional information

| | |
|-------|----------------------------|
| 2,3 l | Oil quantity first filling |
| 75 mm | Maximum height oil level |
| 55 mm | Minimum height oil level |



View product details on medias

07.05.2026, 15:17:23 UTC

SCHAEFFLER

Temperature range

| | | |
|------------------|--------|----------------------------|
| T _{min} | -20 °C | Operating temperature min. |
|------------------|--------|----------------------------|

| | | |
|------------------|--------|----------------------------|
| T _{max} | 100 °C | Operating temperature max. |
|------------------|--------|----------------------------|