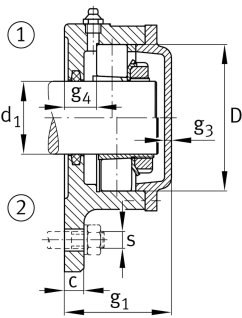
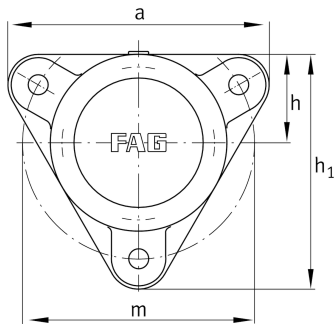

**FAG****F508-WA-L**

Flanged housing

Flanged housing for various bearing types,
wide version with conical bore and clamping
sleeve, closed on one side

Technical information

**Main Dimensions & Performance Data**

d_1	35 mm	Shaft diameter
a	160 mm	Flange width
h_1	143 mm	Height flange
	3	Number of fastening holes
$\approx m$	2,9 kg	Weight

Dimensions

	M10x1	Connection thread for lubrication
c	12 mm	Thickness of flange
D	80 mm	Outside diameter bearing
g_4	22 mm	Distance flange to bearing seat
h	54 mm	Distance shaft axis
m	140 mm	Pich circle diameter fixing holes
s	M12	Size of fixing screws