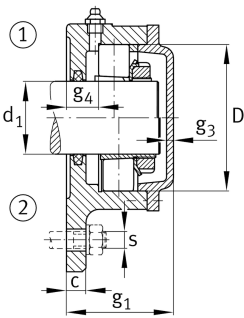
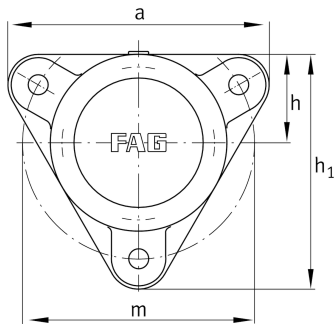

**FAG****F509-A-L**

Flanged housing

Flanged housing for various bearing types,
with conical bore and clamping sleeve, closed
on one side

Technical information

**Main Dimensions & Performance Data**

d_1	40 mm	Shaft diameter
a	180 mm	Flange width
h_1	160 mm	Height flange
	3	Number of fastening holes
$\approx m$	3,499 kg	Weight

Dimensions

	M10x1	Connection thread for lubrication
c	15 mm	Thickness of flange
D	85 mm	Outside diameter bearing
g_4	22 mm	Distance flange to bearing seat
h	60 mm	Distance shaft axis
m	160 mm	Pich circle diameter fixing holes
s	M12	Size of fixing screws