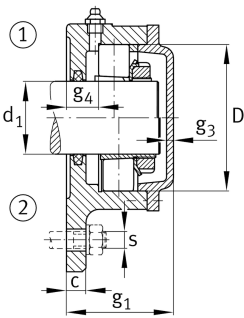

**FAG****F509-WA-L**

Flanged housing

Flanged housing for various bearing types,  
wide version with conical bore and clamping  
sleeve, closed on one side

## Technical information

**Main Dimensions & Performance Data**

$d_1$	40 mm	Shaft diameter
a	180 mm	Flange width
$h_1$	160 mm	Height flange
	3	Number of fastening holes
$\approx m$	3,7 kg	Weight

**Dimensions**

	M10x1	Connection thread for lubrication
c	15 mm	Thickness of flange
D	85 mm	Outside diameter bearing
$g_4$	22 mm	Distance flange to bearing seat
h	60 mm	Distance shaft axis
m	160 mm	Pich circle diameter fixing holes
s	M12	Size of fixing screws