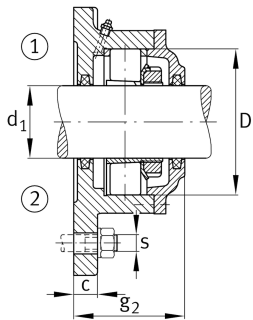

**FAG****F511-WB-L**

Flanged housing

Flanged housing for various bearing types,
wide version with conical bore and clamping
sleeve, continuous shaft

Technical information

**Main Dimensions & Performance Data**

| | | |
|----------------|----------|-------------------------------------|
| d ₁ | 50 mm | Shaft diameter |
| a | 190 mm | Flange width |
| h ₁ | 170 mm | Height flange |
| g ₂ | 82 mm | Total width with lid g ₂ |
| | 3 | Number of fastening holes |
| ≈m | 4,394 kg | Weight |

Dimensions

| | | |
|----------------|--------|-----------------------------------|
| | M10x1 | Connection thread for lubrication |
| c | 16 mm | Thickness of flange |
| D | 100 mm | Outside diameter bearing |
| g ₄ | 25 mm | Distance flange to bearing seat |
| h | 65 mm | Distance shaft axis |
| m | 170 mm | Pich circle diameter fixing holes |
| s | M12 | Size of fixing screws |