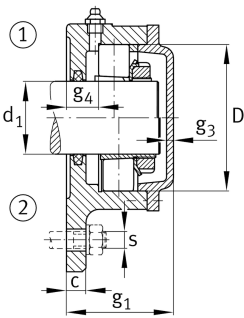
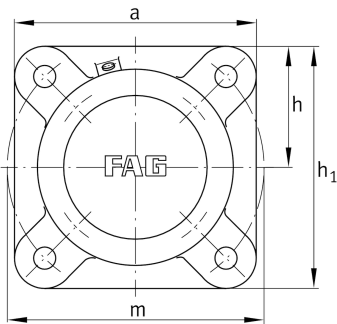

**FAG****F516-A-L**

Flanged housing

Flanged housing for various bearing types,
with conical bore and clamping sleeve, closed
on one side

Technical information

**Main Dimensions & Performance Data**

d_1	70 mm	Shaft diameter
a	196 mm	Flange width
h_1	196 mm	Height flange
	4	Number of fastening holes

$\approx m$	9,775 kg	Weight
-------------	----------	--------

Dimensions

	M10x1	Connection thread for lubrication
c	25 mm	Thickness of flange
D	140 mm	Outside diameter bearing
g_4	32 mm	Distance flange to bearing seat
h	98 mm	Distance shaft axis
m	215 mm	Pich circle diameter fixing holes
s	M16	Size of fixing screws