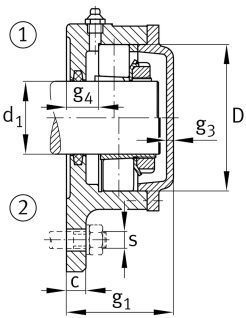
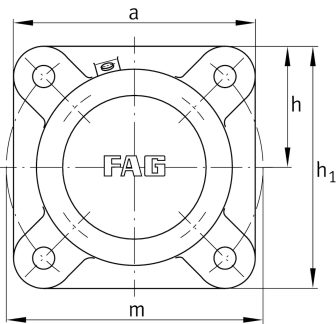

**FAG****F522-A-L**

Flanged housing

Flanged housing for various bearing types,
with conical bore and clamping sleeve, closed
on one side

Technical information

**Main Dimensions & Performance Data**

d_1	100 mm	Shaft diameter
a	270 mm	Flange width
h_1	270 mm	Height flange
	4	Number of fastening holes

$\approx m$	21,949 kg	Weight
-------------	-----------	--------

Dimensions

	M10x1	Connection thread for lubrication
c	30 mm	Thickness of flange
D	200 mm	Outside diameter bearing
g_4	30 mm	Distance flange to bearing seat
h	135 mm	Distance shaft axis
m	310 mm	Pich circle diameter fixing holes
s	M20	Size of fixing screws