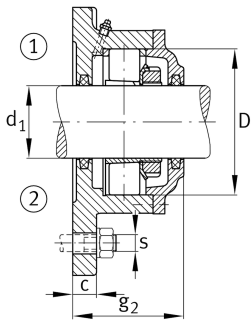
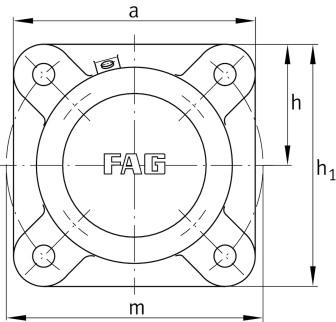

**FAG****F522-WB-L**

Flanged housing

Flanged housing for various bearing types,  
wide version with conical bore and clamping  
sleeve, continuous shaft

## Technical information

**Main Dimensions & Performance Data**

d <sub>1</sub>	100 mm	Shaft diameter
a	270 mm	Flange width
h <sub>1</sub>	270 mm	Height flange
g <sub>2</sub>	137 mm	Total width with lid g <sub>2</sub>
	4	Number of fastening holes
≈m	22 kg	Weight

**Dimensions**

	M10x1	Connection thread for lubrication
c	30 mm	Thickness of flange
D	200 mm	Outside diameter bearing
g <sub>4</sub>	30 mm	Distance flange to bearing seat
h	135 mm	Distance shaft axis
m	310 mm	Pich circle diameter fixing holes
s	M20	Size of fixing screws