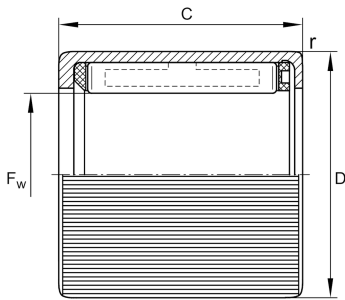
**HF0306-KF-R** **Drawn cup roller clutch**

Drawn cup roller clutches with plastic springs and knurled outer ring

Technical information**Main Dimensions & Performance Data**

F_w	3 mm	Under roller diameter
D	6,5 mm	Outside diameter
C	6 mm	Width, outer ring
r_{min}	0,3 mm	Minimum chamfer dimension
$M_{d per}$	0,06 Nm	Permissible torque
n_{GW}	45.000 1/min	Limiting speed for rotating shaft
n_{GA}	8.000 1/min	Limiting speed for rotating outer ring
$\approx m$	0,717 g	Weight

Temperature range

T_{min}	-10 °C	Operating temperature min.
T_{max}	70 °C	Operating temperature max.

Additional information

HK0306-TV	Drawn cup needle roller bearings for radial bearing arrangement
-----------	---

Characteristics

- Grease Lubrication
- Not sealed
- Small design envelope
- One way clutch