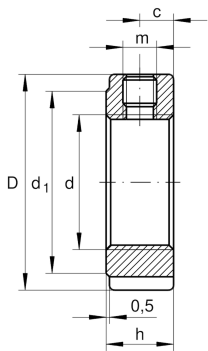

**ZMA100/140**

Precision locknut

Precision locknuts ZMA, locking pegs, radially arranged, heavy series

Technical information

**Main Dimensions & Performance Data**

d	M100X2	Thread
D	140 mm	Outside diameter
M _A	20 Nm	Mounting torque set screw
F _{aB}	940.000 N	Breaking load, axial
M _L	425 Nm	Breakawag
M _{AL}	250 Nm	Mounting torque reference
M _M	82,8 kg*cm ²	Mass moment of inertia
≈m	2,23 kg	Weight

Dimensions

d ₁	128 mm	Plant diameter outside
t	5 mm	Hight retaining slot
b	12 mm	Width retaining slot
c	19 mm	Distance bore
m	M10	Threaded - threaded pin