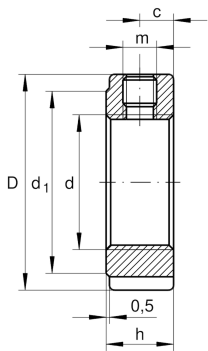

**ZM85**

## Precision locknut

Precision locknut ZM, accessory ZM..

## Technical information

**Main Dimensions & Performance Data**

d	M85X2	Thread
D	110 mm	Outside diameter
h	18 mm	Height
M <sub>A</sub>	15 Nm	Mounting torque set screw
F <sub>aB</sub>	385.000 N	Breaking load, axial
M <sub>L</sub>	320 Nm	Breakawag
M <sub>AL</sub>	190 Nm	Mounting torque reference
M <sub>M</sub>	13,1 kg*cm <sup>2</sup>	Mass moment of inertia
≈m	0,524 kg	Weight

**Dimensions**

d <sub>1</sub>	102 mm	Plant diameter outside
t	3,5 mm	Hight retaining slot
b	8 mm	Width retaining slot
c	9 mm	Distance bore
m	M8	Threaded - threaded pin