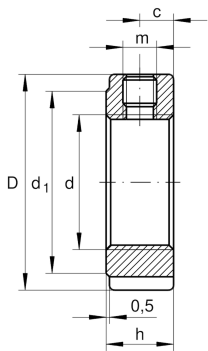

**ZMA15/33**

Precision locknut

Precision locknuts ZMA, locking pegs, radially arranged, heavy series

Technical information

**Main Dimensions & Performance Data**

d	M15X1	Thread
D	33 mm	Outside diameter
h	16 mm	Height
M _A	3 Nm	Mounting torque set screw
F _{aB}	106.000 N	Breaking load, axial
M _L	30 Nm	Breakawag
M _{AL}	10 Nm	Mounting torque reference
M _M	0,14 kg*cm ²	Mass moment of inertia
≈m	80 g	Weight

Dimensions

d ₁	28 mm	Plant diameter outside
t	2 mm	Hight retaining slot
b	4 mm	Width retaining slot
c	8 mm	Distance bore
m	M5	Threaded - threaded pin