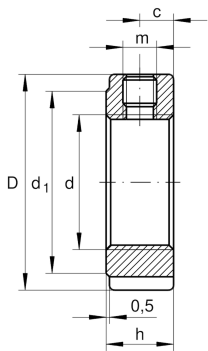

**ZMA30/52**

## Precision locknut

Precision locknuts ZMA, locking pegs, radially arranged, heavy series

## Technical information

**Main Dimensions & Performance Data**

|                 |                        |                           |
|-----------------|------------------------|---------------------------|
| d               | M30X1,5                | Thread                    |
| D               | 52 mm                  | Outside diameter          |
| h               | 22 mm                  | Height                    |
| M <sub>A</sub>  | 5 Nm                   | Mounting torque set screw |
| F <sub>aB</sub> | 270.000 N              | Breaking load, axial      |
| M <sub>L</sub>  | 70 Nm                  | Breakawag                 |
| M <sub>AL</sub> | 32 Nm                  | Mounting torque reference |
| M <sub>M</sub>  | 1,1 kg*cm <sup>2</sup> | Mass moment of inertia    |
| ≈m              | 0,233 kg               | Weight                    |

**Dimensions**

|                |       |                         |
|----------------|-------|-------------------------|
| d <sub>1</sub> | 47 mm | Plant diameter outside  |
| t              | 2 mm  | Hight retaining slot    |
| b              | 5 mm  | Width retaining slot    |
| c              | 11 mm | Distance bore           |
| m              | M6    | Threaded - threaded pin |