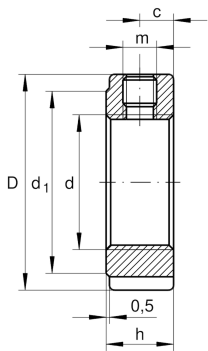

**ZMA50/92**

Precision locknut

Precision locknuts ZMA, locking pegs, radially arranged, heavy series

Technical information

**Main Dimensions & Performance Data**

d	M50X1,5	Thread
D	92 mm	Outside diameter
h	32 mm	Height
M _A	15 Nm	Mounting torque set screw
F _{aB}	680.000 N	Breaking load, axial
M _L	130 Nm	Breakawag
M _{AL}	85 Nm	Mounting torque reference
M _M	16,1 kg*cm ²	Mass moment of inertia
≈m	1,138 kg	Weight

Dimensions

d ₁	84 mm	Plant diameter outside
t	3,5 mm	Hight retaining slot
b	8 mm	Width retaining slot
c	16 mm	Distance bore
m	M8	Threaded - threaded pin