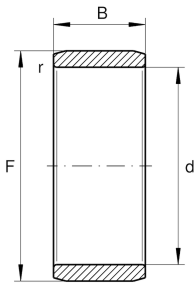
**IR32X37X20-XL**

Inner ring

Inner ring IR..-XL, cylindrical

X-life

Technical information

**Your current product variant**

Lubrication hole	Without
Special features	Without

Main Dimensions & Performance Data

d	32 mm	Bore diameter
F	37 mm	Raceway diameter inner ring
B	20 mm	Width
	0 mm	Raceway diameter upper tolerance
	-0,009 mm	Raceway diameter lower tolerance
r _{min}	0,3 mm	Minimum chamfer dimension
≈m	0,041 kg	Weight