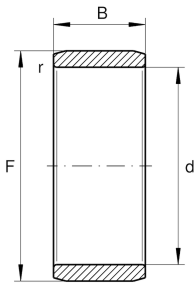
**IR80X90X30-XL**

Inner ring

Inner ring IR..-XL, cylindrical

X-life

Technical information

**Your current product variant**

| | |
|------------------|---------|
| Lubrication hole | Without |
| Special features | Without |

Main Dimensions & Performance Data

| | | |
|------------------|-----------|----------------------------------|
| d | 80 mm | Bore diameter |
| F | 90 mm | Raceway diameter inner ring |
| B | 30 mm | Width |
| | -0,004 mm | Raceway diameter upper tolerance |
| | -0,017 mm | Raceway diameter lower tolerance |
| r _{min} | 1 mm | Minimum chamfer dimension |
| ≈m | 0,304 kg | Weight |