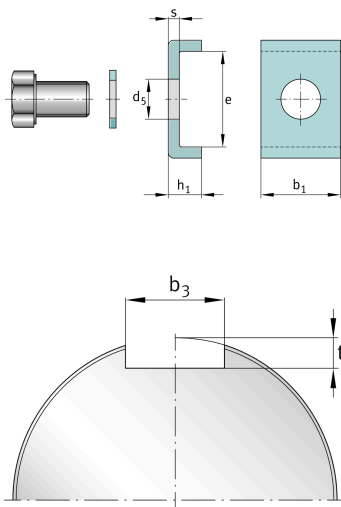
**FAG****MS3152**

Securing plate

Securing plate MS, locknut, DIN5406

## Technical information

**Main Dimensions & Performance Data**

b <sub>1</sub>	24 mm	Length retaining ring
e	25,5 mm	Width inner retaining ring
h <sub>1</sub>	12 mm	Hight retaining ring
≈m	59 g	Weight

**Mounting dimensions**

b <sub>3</sub>	26 mm	Width retaining slot
t	9 mm	Hight retaining slot

**Dimensions**

s	4 mm	Thickness
d <sub>5</sub>	11 mm	Diameter fixing hole spacing

**Additional information**

M10x20	Hexagonal bolt
51 Nm	Mounting torque screw