

**FAG****KM1**

Locknut

Locknuts KM, main dimensions to DIN 981

## Technical information

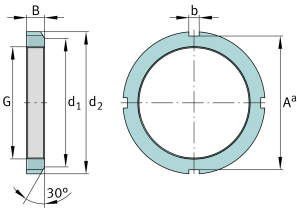

### Main Dimensions & Performance Data

G	M12x1	Thread
d <sub>2</sub>	22 mm	Outerside diameter
B	4 mm	Width
≈m	7 g	Weight

### Mounting dimensions

d <sub>1</sub>	17 mm	Chamfer diameter
b	3 mm	Width retaining slot
A <sup>a</sup>	18 mm	Groove base distance

### Additional information

F	6.000 N	Axial load capacity, static
	MB1	Fuse
	30 °	Chamfer angle