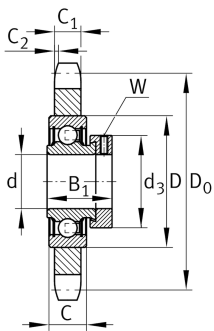
**KSR20-B0-08-10-18-15** [↗](#)

## Roller chain idler sprocket unit

Roller chain idler sprocket units KSR...B0,  
sprocket made from steel or sintered iron

## Technical information

**Main Dimensions & Performance Data**

d	20 mm	Bore diameter
d	0,018 mm	Upper tolerance
d	0 mm	Lower tolerance
C <sub>1</sub>	7 mm	Thickness of sprocket
D <sub>0</sub>	73,1 mm	Pitch circle diameter (gearing)
D <sub>k</sub>	78,6 mm	Tip diameter (gearing)
≈m	0,26 kg	Weight

**Mounting dimensions**

p	12,7 mm	Tooth set
z	18	Number of teeth
	x	ISO chain
	x	ANSI chain
W	M6 X 0,75 mm	Width accros flats



### Dimensions

C <sub>2</sub>	1,1 mm	Chamfer width
D	47 mm	Outside diameter
B <sub>1</sub>	31 mm	Locking collar total width
C	14 mm	Width, outer ring
d <sub>3</sub>	33 mm	Outside diameter locking collar/locknut
d <sub>3</sub>	33 mm	Outside diameter eccentric locking collar
W	3 mm	Width of flats
B <sub>1</sub>	31 mm	Locking collar width