

**KBO12-PP**

Linear Ball Bearing

Linear ball bearings KBO...-PP, machined range, open design, sealed on all sides, corrosion-resistant design possible

Technical information

Your current product variant

| | |
|-----------|----|
| Size code | 12 |
|-----------|----|

Main Dimensions & Performance Data

| | | |
|-------------|---------|---------------------|
| F_w | 12 mm | Bore diameter |
| D | 22 mm | Outside diameter |
| L | 32 mm | Length |
| | h12 | Tolerance |
| C_{max} | 600 N | Load capacity dyn. |
| $C_{0 max}$ | 445 N | Load capacity stat. |
| $\approx m$ | 28,99 g | Weight |

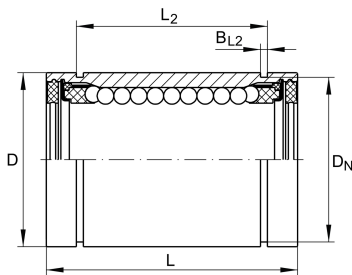



Mounting dimensions

| | | |
|-----------------|---------|-------------------------|
| B ₂ | 7,7 mm | Width of sector opening |
| L ₂ | 22,6 mm | |
| | H13 | Tolerance |
| B _{L2} | 1,3 mm | |
| D _N | 21 mm | |
| T ₄ | 1,2 mm | |
| N ₄ | 2,2 mm | |
| N ₂ | 1,5 mm | |
| α | 78 ° | Angle of sector opening |
| β | 64 ° | |
| | 4 | Number of rows balls |