

**KBO12-PP-AS**

Linear Ball Bearing

Linear ball bearings KBO...-PP-AS, machined range, open design, sealed on all sides, with relubrication facility, corrosion-resistant design possible

Technical information

Your current product variant

Size code	12
-----------	----

Main Dimensions & Performance Data

F _w	12 mm	Bore diameter
D	22 mm	Outside diameter
L	32 mm	Length
	h12	Tolerance
C _{max}	600 N	Load capacity dyn.
C _{0 max}	445 N	Load capacity stat.
≈m	28,99 g	Weight

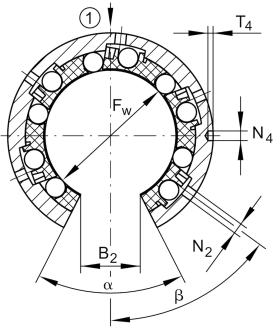
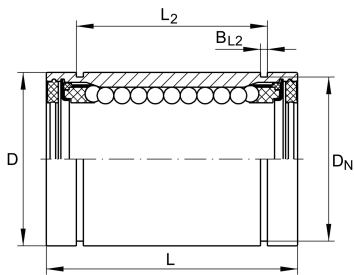



Mounting dimensions

B ₂	7,7 mm	Width of sector opening
L ₂	22,6 mm	
	H13	Tolerance
B _{L2}	1,3 mm	
D _N	21 mm	
T ₄	1,2 mm	
N ₄	2,2 mm	
N ₂	1,5 mm	
α	78 °	Angle of sector opening
β	64 °	
	4	Number of rows balls