

**KBO16-PP**

## Linear Ball Bearing

Linear ball bearings KBO...-PP, machined range, open design, sealed on all sides, corrosion-resistant design possible

## Technical information

## Your current product variant

Size code	16
-----------	----

## Main Dimensions &amp; Performance Data

$F_w$	16 mm	Bore diameter
$D$	26 mm	Outside diameter
$L$	36 mm	Length
	h12	Tolerance
$C_{max}$	800 N	Load capacity dyn.
$C_{0 max}$	620 N	Load capacity stat.
$\approx m$	37,81 g	Weight

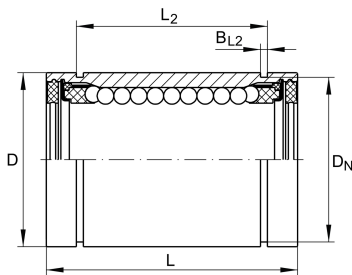



### Mounting dimensions

B <sub>2</sub>	10,1 mm	Width of sector opening
L <sub>2</sub>	24,6 mm	
	H13	Tolerance
B <sub>L2</sub>	1,3 mm	
D <sub>N</sub>	24,9 mm	
T <sub>4</sub>	1,2 mm	
N <sub>4</sub>	2,2 mm	
N <sub>2</sub>	2 mm	
α	78 °	Angle of sector opening
β	64 °	
	4	Number of rows balls