

**KBO16-PP-AS**

Linear Ball Bearing

Linear ball bearings KBO...-PP-AS, machined range, open design, sealed on all sides, with relubrication facility, corrosion-resistant design possible

Technical information

Your current product variant

Size code	16	
Design	PP-AS	Sealed, relubrication facility

Main Dimensions & Performance Data

F_w	16 mm	Bore diameter
D	26 mm	Outside diameter
L	36 mm	Length
	h12	Tolerance
C_{max}	800 N	Load capacity dyn.
$C_{0 max}$	620 N	Load capacity stat.
$\approx m$	37,36 g	Weight

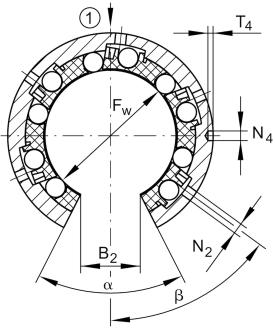
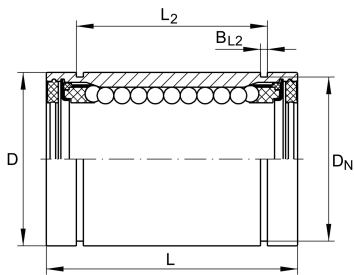



Mounting dimensions

B ₂	10,1 mm	Width of sector opening
L ₂	24,6 mm	
	H13	Tolerance
B _{L2}	1,3 mm	
D _N	24,9 mm	
T ₄	1,2 mm	
N ₄	2,2 mm	
N ₂	2 mm	
α	78 °	Angle of sector opening
β	64 °	
	4	Number of rows balls