

**KBO20-PP**

Linear Ball Bearing

Linear ball bearings KBO...-PP, machined range, open design, sealed on all sides, corrosion-resistant design possible

Technical information

Your current product variant

Size code	20
-----------	----

Main Dimensions & Performance Data

F _w	20 mm	Bore diameter
D	32 mm	Outside diameter
L	45 mm	Length
	h12	Tolerance
C _{max}	1.600 N	Load capacity dyn.
C _{0 max}	1.280 N	Load capacity stat.
≈m	77,64 g	Weight

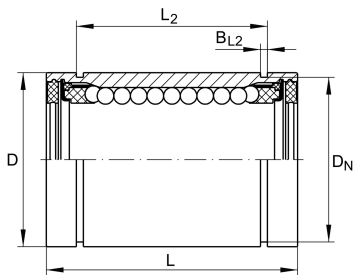



Mounting dimensions

B ₂	10 mm	Width of sector opening
L ₂	31,2 mm	
	H13	Tolerance
B _{L2}	1,6 mm	
D _N	30,3 mm	
T ₄	1,2 mm	
N ₄	2,2 mm	
N ₂	2 mm	
α	60 °	Angle of sector opening
β	52 °	
	5	Number of rows balls