**KBO20-PP-AS**

## Linear Ball Bearing

Linear ball bearings KBO...-PP-AS, machined range, open design, sealed on all sides, with relubrication facility, corrosion-resistant design possible

## Technical information

## Your current product variant

Size code	20	
Design	PP-AS	Sealed, relubrication facility

## Main Dimensions &amp; Performance Data

F <sub>w</sub>	20 mm	Bore diameter
D	32 mm	Outside diameter
L	45 mm	Length
	h12	Tolerance
C <sub>max</sub>	1.600 N	Load capacity dyn.
C <sub>0 max</sub>	1.280 N	Load capacity stat.
≈m	74,21 g	Weight

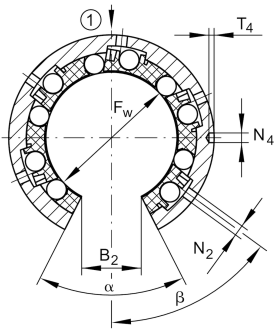
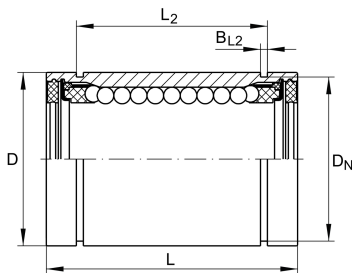



### Mounting dimensions

B <sub>2</sub>	10 mm	Width of sector opening
L <sub>2</sub>	31,2 mm	
	H13	Tolerance
B <sub>L2</sub>	1,6 mm	
D <sub>N</sub>	30,3 mm	
T <sub>4</sub>	1,2 mm	
N <sub>4</sub>	2,2 mm	
N <sub>2</sub>	2 mm	
α	60 °	Angle of sector opening
β	52 °	
	5	Number of rows balls