

**KBO25**

## Linear Ball Bearing

Linear ball bearings KBO..., machined range,  
open design, corrosion-resistant design  
possible

## Technical information

## Your current product variant

Size code	25
-----------	----

## Main Dimensions &amp; Performance Data

$F_w$	25 mm	Bore diameter
$D$	40 mm	Outside diameter
$L$	58 mm	Length
	h12	Tolerance
$C_{max}$	2.850 N	Load capacity dyn.
$C_0_{max}$	2.300 N	Load capacity stat.
$\approx m$	0,156 kg	Weight

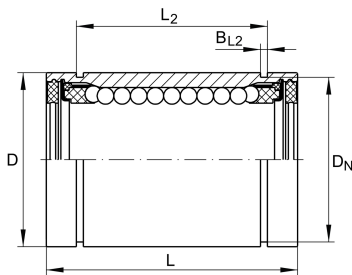



### Mounting dimensions

B <sub>2</sub>	12,5 mm	Width of sector opening
L <sub>2</sub>	43,7 mm	
	H13	Tolerance
B <sub>L2</sub>	1,85 mm	
D <sub>N</sub>	37,5 mm	
T <sub>4</sub>	1,5 mm	
N <sub>4</sub>	3 mm	
N <sub>2</sub>	2,5 mm	
α	60 °	Angle of sector opening
β	53 °	
	5	Number of rows balls