

**KBO25-PP-AS**

## Linear Ball Bearing

Linear ball bearings KBO...-PP-AS, machined range, open design, sealed on all sides, with relubrication facility, corrosion-resistant design possible

## Technical information

## Your current product variant

Size code	25	
Design	PP-AS	Sealed, relubrication facility

## Main Dimensions &amp; Performance Data

F <sub>w</sub>	25 mm	Bore diameter
D	40 mm	Outside diameter
L	58 mm	Length
	h12	Tolerance
C <sub>max</sub>	2.850 N	Load capacity dyn.
C <sub>0 max</sub>	2.300 N	Load capacity stat.
≈m	0,157 kg	Weight

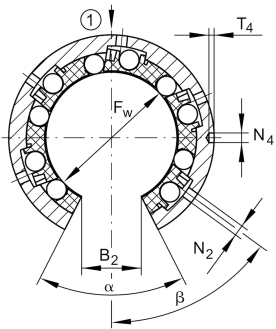
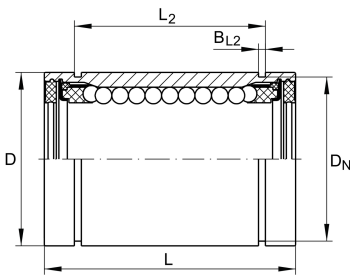



### Mounting dimensions

B <sub>2</sub>	12,5 mm	Width of sector opening
L <sub>2</sub>	43,7 mm	
	H13	Tolerance
B <sub>L2</sub>	1,85 mm	
D <sub>N</sub>	37,5 mm	
T <sub>4</sub>	1,5 mm	
N <sub>4</sub>	3 mm	
N <sub>2</sub>	2,5 mm	
α	60 °	Angle of sector opening
β	53 °	
	5	Number of rows balls