

**KBO30-PP**

## Linear Ball Bearing

Linear ball bearings KBO...-PP, machined range, open design, sealed on all sides, corrosion-resistant design possible

## Technical information

## Your current product variant

Size Code	30
-----------	----

## Main Dimensions &amp; Performance Data

$F_w$	30 mm	Bore diameter
$D$	47 mm	Outside diameter
$L$	68 mm	Length
	h12	Tolerance
$C_{max}$	3.700 N	Load capacity dyn.
$C_0_{max}$	3.000 N	Load capacity stat.
$\approx m$	0,256 kg	Weight

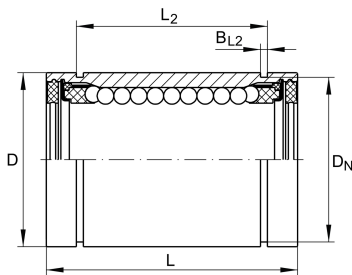



### Mounting dimensions

B <sub>2</sub>	13,6 mm	Width of sector opening
L <sub>2</sub>	51,7 mm	
	H13	Tolerance
B <sub>L2</sub>	1,85 mm	
D <sub>N</sub>	44,5 mm	
T <sub>4</sub>	1,5 mm	
N <sub>4</sub>	3 mm	
N <sub>2</sub>	2,5 mm	
α	54 °	Angle of sector opening
β	55 °	
	5	Number of rows balls