

**KBO30-PP-AS**

Linear Ball Bearing

Linear ball bearings KBO...-PP-AS, machined range, open design, sealed on all sides, with relubrication facility, corrosion-resistant design possible

Technical information

Your current product variant

Size code	30	
Design	PP-AS	Sealed, relubrication facility

Main Dimensions & Performance Data

F _w	30 mm	Bore diameter
D	47 mm	Outside diameter
L	68 mm	Length
	h12	Tolerance
C _{max}	3.700 N	Load capacity dyn.
C _{0 max}	3.000 N	Load capacity stat.
≈m	0,256 kg	Weight

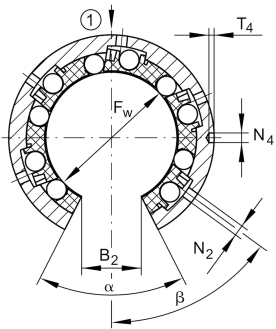
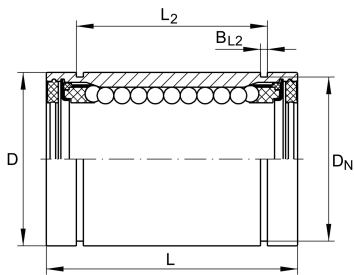



Mounting dimensions

B ₂	13,6 mm	Width of sector opening
L ₂	51,7 mm	
	H13	Tolerance
B _{L2}	1,85 mm	
D _N	44,5 mm	
T ₄	1,5 mm	
N ₄	3 mm	
N ₂	2,5 mm	
α	54 °	Angle of sector opening
β	55 °	
	5	Number of rows balls