

**KBO50-PP-AS**

Linear Ball Bearing

Linear ball bearings KBO...-PP-AS, machined range, open design, sealed on all sides, with relubrication facility, corrosion-resistant design possible

Technical information

Your current product variant

Size code	50	
Design	PP-AS	Sealed, relubrication facility

Main Dimensions & Performance Data

F _w	50 mm	Bore diameter
D	75 mm	Outside diameter
L	100 mm	Length
	h12	Tolerance
C _{max}	8.900 N	Load capacity dyn.
C _{0 max}	6.600 N	Load capacity stat.
≈m	0,835 kg	Weight

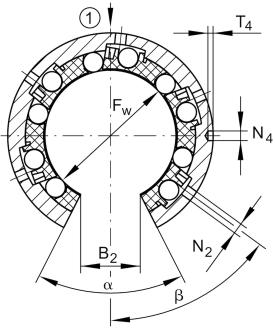
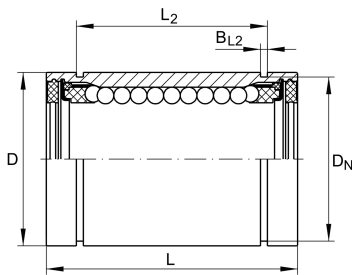



Mounting dimensions

B ₂	22,7 mm	Width of sector opening
L ₂	77,3 mm	
	H13	Tolerance
B _{L2}	2,65 mm	
D _N	72 mm	
T ₄	1,5 mm	
N ₄	3 mm	
N ₂	4 mm	
α	54 °	Angle of sector opening
β	54 °	
	5	Number of rows balls