

RUKS45-D-A-SR [↗](#)

Braking/clamping element

Clamping element RUKS...D-A-SR, for linear recirculating roller bearing and guideway assembly, oil connector on side

Technical information

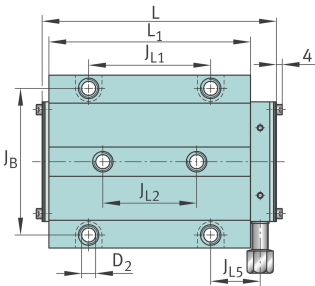
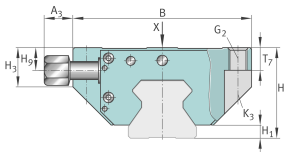

Your current product variant

Size code	45
Version	D
Internal design	A
Oil feed	SR Oil connector on side

Main Dimensions & Performance Data

H	60 mm	Height system
B	118 mm	Width clamping element
L	156,6 mm	Length of clamping element
≈m	4,29 kg	Weight

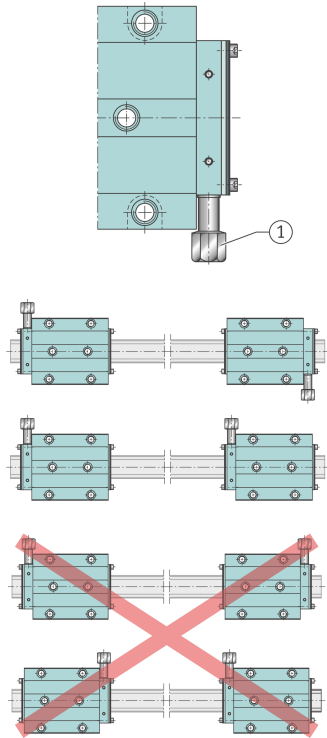

Mounting dimensions

J _B	60 mm	Hole pattern width
A ₃	22 mm	Mounting dimension oil connector
L ₁	134 mm	Length saddle plate
J _{L1}	80 mm	Hole pattern lengthwise
J _{L2}	60 mm	Hole pattern centre
J _{L5}	33,5 mm	Distance
N _{2 max}	6 mm	Max diameter lubrication hole adjacent constr
H ₁	8,7 mm	Space (system)
H ₃	27 mm	
T ₇	15 mm	Depth thread
H ₉	15,8 mm	
G ₂	M12	Size thread above for DIN ISO 4762-12.9
M G ₂	83 Nm	Tightening torque above
K ₃	M10	Size thread below for DIN ISO 4762-12.9
M K ₃	83 Nm	Tightening torque below
D ₂	10,6 mm	Through-bore

Related products

TSX45-E; TSX45-F	Suitable guideway
RUE45-E; RUE45-F	Suitable system