

RUKS55-D-A-SR [↗](#)

Braking/clamping element

Clamping element RUKS...-D-A-SR, for linear recirculating roller bearing and guideway assembly, oil connector on side

Technical information

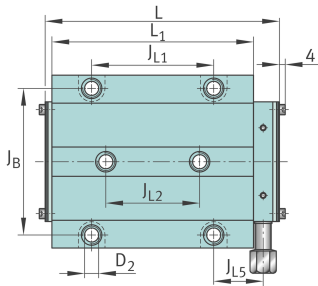
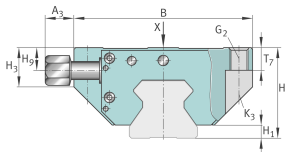

Your current product variant

Size code	55
Version	D
Internal design	A
Oil feed	SR Oil connector on side

Main Dimensions & Performance Data

H	70 mm	Height sytem
B	138 mm	Width clamping element
L	186,3 mm	Length of clamping element
≈m	6,975 kg	Weight

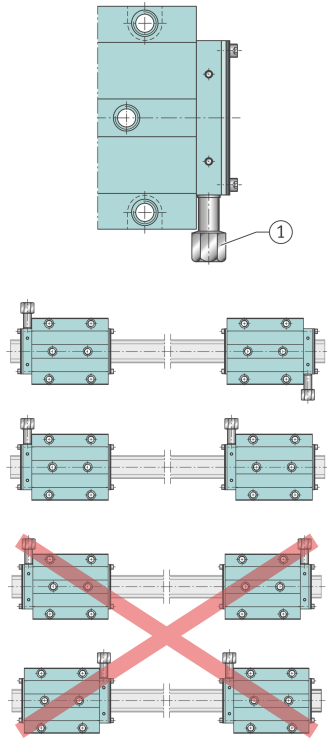

Mounting dimensions

J _B	116 mm	Hole pattern width
A ₃	18,5 mm	Mounting dimension oil connector
L ₁	163 mm	Length saddle plate
J _{L1}	95 mm	Hole pattern lengthwise
J _{L2}	70 mm	Hole pattern centre
J _{L5}	40,5 mm	Distance
N _{2 max}	6 mm	Max diameter lubrication hole adjacent constr
H ₁	11 mm	Space (system)
H ₃	32 mm	
T ₇	18 mm	Depth thread
H ₉	19 mm	
G ₂	M14	Size thread above for DIN ISO 4762-12.9
M G ₂	140 Nm	Tightening torque above
K ₃	M12	Size thread below for DIN ISO 4762-12.9
M K ₃	140 Nm	Tightening torque below
D ₂	12,5 mm	Through-bore

Related products

TSX55-E; TSX55-F	Suitable guideway
RUE55-E; RUE55-F	Suitable system