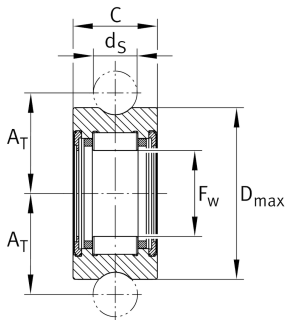
**LFR2202-10-2RSR-RNA** [↗](#)

Yoke type track roller

Yoke type track roller

Technical information

**Your current product variant**

Size code	2202	
Seal	2RSR	double-sided sliding seal
Code	RNA	Without inner ring

Main Dimensions & Performance Data

D_{max}	35 mm	
$\approx m$	51,19 g	Weight

Mounting dimensions

A_T	20,63 mm
F_w	20 mm
C	13,8 mm
d_s	10 mm

Main dimensions

C_{rw}	6.500 N	Effective dynamic load rating as track roller (radial)
C_{0rw}	9.300 N	Effective static load rating as track roller (radial)
C_{urw}	1.310 N	Limit of fatigue load