

RUS38206 [↗](#)

Linear recirculating roller bearing unit

Linear roller bearings with spacer elements
RUS..

Technical information

Your current product variant

Size code	38206
-----------	-------

Main Dimensions & Performance Data

L _{tot}	206 mm	Total length
L	206,7 mm	
B	52 mm	Width
H	38 mm	Height
C	305.000 N	Basic dynamic load rating
C ₀	550.000 N	Basic static load rating
≈m	2,308 kg	Weight

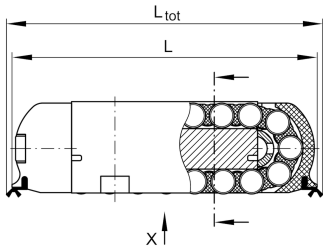
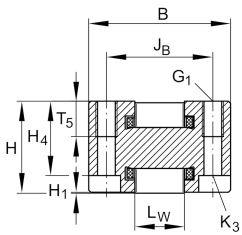

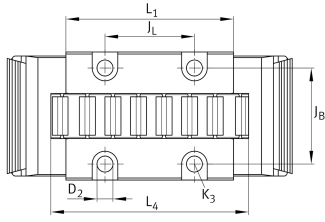

Mounting dimensions

L ₁	158,8 mm	Mounting dimension
J _B	41 mm	Mounting dimension
Tol J _B	± 0,1 mm	Tolerance
J _L	102 mm	
Tol J _L	± 0,1 mm	Tolerance
H ₁	0,2 mm	
L ₄	172 mm	Minimum support length
L _W	20 mm	
H ₄	31 mm	
T ₅	14,2 mm	
G ₁	M8	Fixing screws top (DIN ISO 4762-12.9)
G1 M _A	41 Nm	Tightening torque fixing screws
K ₃	M6	Fixing screws below (DIN ISO 4762-12.9)
K3 M _A max	17 Nm	Tightening torque fixing screws
D ₂	6,9 mm	
	6 mm	

Related products

VUS38206-A	Adjustment gib
UG12553, UGN12553- A, UZ12553, UZN12553-A, UFG6412, UFB7812	Suitable Guide rail