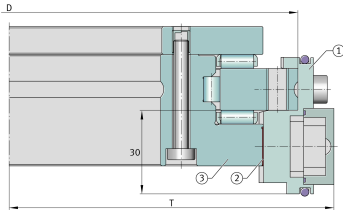

**MHA180-0-6-3-4-N-0768-01,0M-8-1-A** [↗](#)

sensing head

Measuring heads, for radial screw mounting

## Technical information

**Your current product variant**

Cable length	1 m
--------------	-----

**Digital Output**

EnDat22	Electronic interface
---------	----------------------

≈m	115 g	Weight
----	-------	--------

**Main Dimensions & Performance Data**

D	280 mm	Diameter bearing outer ring
---	--------	-----------------------------

H <sub>M</sub>	49 mm	Height
----------------	-------	--------

**Mounting dimensions**

J <sub>M</sub>	18 mm	Bore distance
----------------	-------	---------------

T	153,2 mm	Distance bearing center measuring head
---	----------	--

**Additional information**

5 Nm	Tightening torque
------	-------------------

0,5 Nm	Tightening torque upper tolerance
--------	-----------------------------------

-0,5 Nm	Tightening torque lower tolerance
---------	-----------------------------------

2x ISO4762- M6x20-8.8	Cylinder head screws
--------------------------	----------------------



View product details on medias

16.06.2026, 19:56:53 UTC

SCHAEFFLER

### Cable

M12x1	Thread plug connector
8	Pins plug connector