

**GE600-DO**

Spherical plain bearing

Radial spherical plain bearing, requiring maintenance, sliding contact surface: steel/steel, DIN ISO 12240-1, dimension series C, open design

Technical information

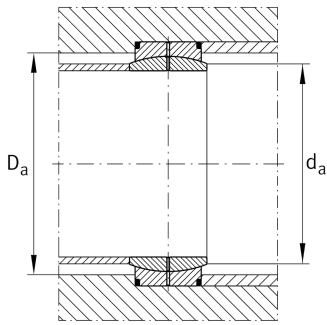

Your current product variant

Maintenance	Maintenance required
Material	Steel
Sealing	Without
Radial internal clearance	CN (Group N) Normal internal clearance
Coating	Durotect M Inner- and outer ring coated with Durotect M (Manganese Phosphate)

Main Dimensions & Performance Data

d	600 mm	Bore diameter bearing
D	800 mm	Outside diameter bearing
B	272 mm	Width inner ring
C_r	20.200.000 N	Basic dynamic load rating, radial
C_{0r}	77.700.000 N	Basic static load rating, radial
$\approx m$	407,28 kg	Weight

Mounting dimensions

$r_{1\text{min}}$	2 mm	Edge Spacing
$r_{2\text{min}}$	5 mm	Edge Spacing
$d_{a\text{max}}$	645 mm	Connection measure Inner ring
$D_{a\text{min}}$	667 mm	Housing Connection Diameter



Dimensions

C	230 mm	Width Outer ring
d_K	700 mm	Ball diameter
α	3,6 °	Tilt angle
d_{OT}	0 mm	Bore diameter bearing, upper tolerance
d_{UT}	-0,05 mm	Bore diameter bearing, lower tolerance
D_{OT}	0 mm	Outside diameter, upper tolerance
D_{UT}	-0,075 mm	Outside diameter, lower tolerance
B_{OT}	0 mm	Width inner ring, upper tolerance
B_{UT}	-0,5 mm	Width inner ring, lower tolerance
C_{OT}	0 mm	Width outer ring, upper tolerance
C_{UT}	-1,1 mm	Width outer ring, lower tolerance
G_r	0,16 - 0,32	Radial Clearance
G_{rmax}	0,32 mm	Radial clearance, maximum
G_{rmin}	0,16 mm	Radial clearance, minimum

Temperature range

T_{min}	-60 °C	Operating temperature min.
T_{max}	200 °C	Operating temperature max.



Characteristics



Radial load



Axial load in one direction



Axial load in two directions



Grease Lubrication



Not sealed



Large bearing



Static angular error and misalignment



Dynamic angular error and misalignment