

**XU120179-ZT** [↗](#)

Slewing ring, Crossed roller bearing, without gear teeth

Crossed roller bearings without gear teeth,
sealed on both sides

Technical information

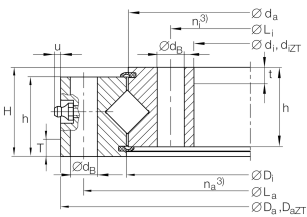

Your current product variant

Centering	ZT	Centering on inner and outer ring
-----------	----	-----------------------------------

Main Dimensions & Performance Data

d_i	124,5 mm	Bore Diameter
$d_i ZT$	126,5 mm	Diameter centring inner ring
	IT8	Diameter centring inner ring tolerance
t	5 mm	Length centering inner ring
D_a	234 mm	Outside Diameter
$D_a ZT$	232 mm	Diameter centring outer ring
	-IT8	Diameter centring outer ring tolerance
T	5 mm	Length centering outer ring
H	35 mm	Height
$\approx m$	7,015 kg	Weight



Dimensions

D_i	180 mm	Inner diameter outer ring
	0,2 mm	Inner diameter outer ring upper tolerance
	-0,2 mm	Inner diameter outer ring lower tolerance
h_a	30 mm	Height outer ring
L_a	214 mm	Pitchcircle diameter fixing holes outer ring
n_a	12	Number of fixing holes in outer ring
d_a	178 mm	Outside diameter inner ring
	0,2 mm	Outside diameter inner ring upper tolerance
	-0,2 mm	Outside diameter inner ring lower tolerance
h_i	30 mm	Height of inner ring
d_B	11 mm	Fixing bore
L_i	144,5 mm	Pitchcircle diameter fixing holes inner ring
n_i	12	Number of fixing holes in inner ring
u_{max}	6 mm	Max. protrusion lubrication nipple
VSP min	0 mm	Min. bearing preload
VSP max	0,02 mm	Maximum bearing preload

Temperature range

T_{min}	-30 °C	Operating temperature min.
T_{max}	80 °C	Operating temperature max.

Calculation factors

C_a	104.000 N	Basic dynamic load rating, axial
C_r	74.000 N	Basic dynamic load rating, radial (for radial load only)
C_{0a}	193.000 N	Basic static load rating, axial
C_{0r}	94.000 N	Basic static load rating, radial (for radial load only)
F_{rzu}	33.600 N	Max. radial load screws



Characteristics



Radial load



Axial load in one direction



Axial load in two directions



Moments about all axes



Grease Lubrication



Sealed on both sides